

Functional Relationships Diagram

The functional relationships of a typical Inpatient Unit in the Racetrack Model are demonstrated in the diagram below. Other Models will need to have similar relationships but implemented in different ways. Refer to the typical models below.

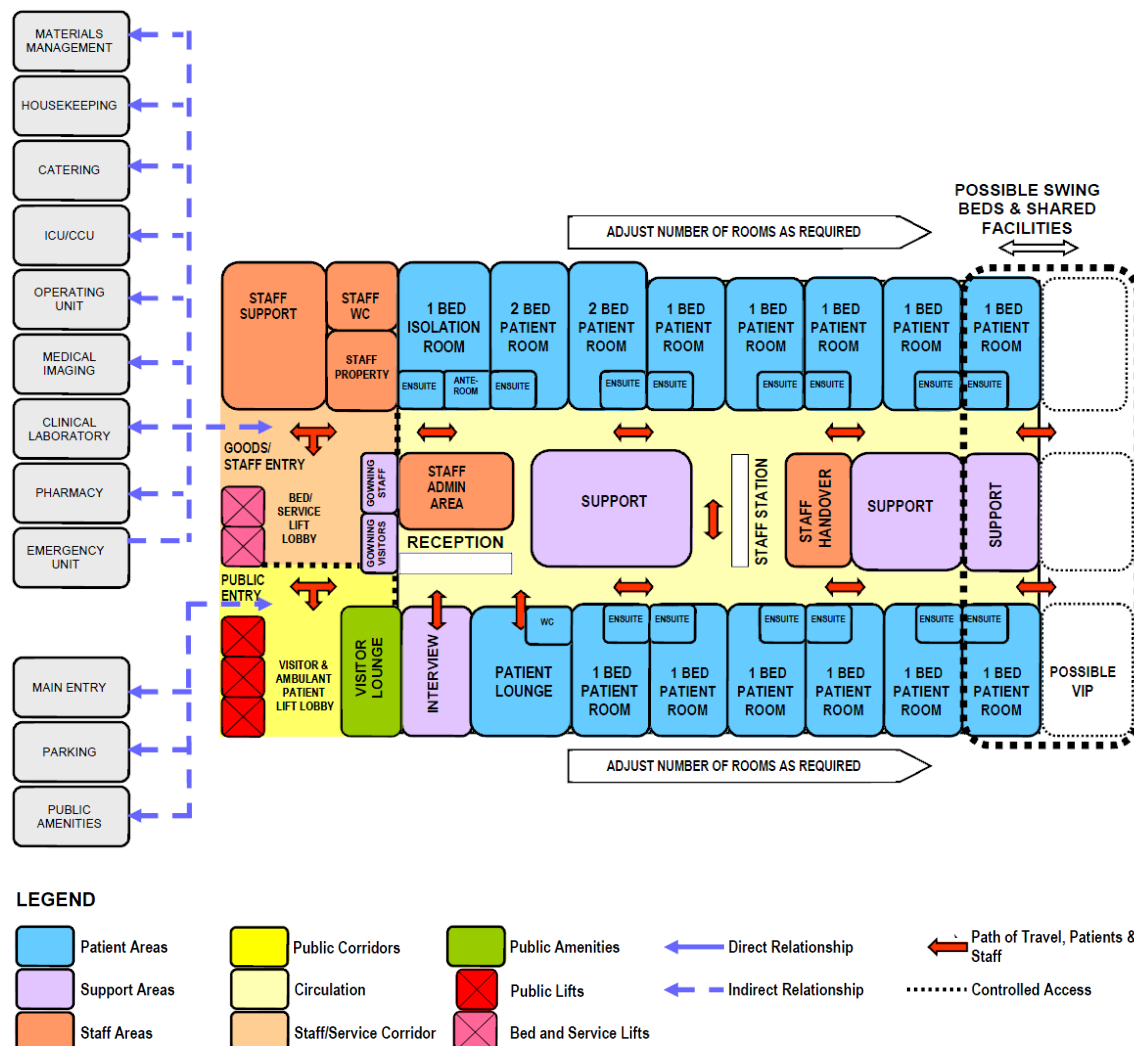

Important and desirable external relationships outlined in the diagram include:

- Clear Goods/Service/Staff Entrance
 - Access to/ from key clinical units associated with patient arrivals/ transfers via service corridor
 - Access to/ from key diagnostic facilities via service corridor
 - Entry for staff via the public or service corridor
 - Access to shared staff break and property areas via service corridor
 - Access to/ from Materials, Catering and Housekeeping Units via service corridor
- Clear Public Entrance
 - Entry for ambulant patients and visitors directly from dedicated lift and public corridor
 - Access to / from key public areas, such as the main entrance, parking and cafeteria from the public corridor and lift

Important and desirable internal relationships outlined in the diagram include:

- Bed Room(s) on the perimeter arranged in a racetrack model (although other models are also suitable).
- Staff Station is centralised for maximum patient visibility and access.